



# EAPRI'S RECOMMENDATIONS BENEFITS

LISBON ATC TOWER

### TRAINING AND BRIEFINGS

- Safety recommendations included yearly on training, refreshments and briefings.

### TAXI INSTRUCTIONS

- Clearance limit on all taxi instructions;
- Standard taxi routes:
  - NVO vs LVO.
- Progressive taxi instructions (RWY 21);
- ATC clearance prior to taxi;
- Vehicle progress strips;
- Line-up/ take-off clearance close to holding point + when ready;
- Avoidance of premature landing clearances.

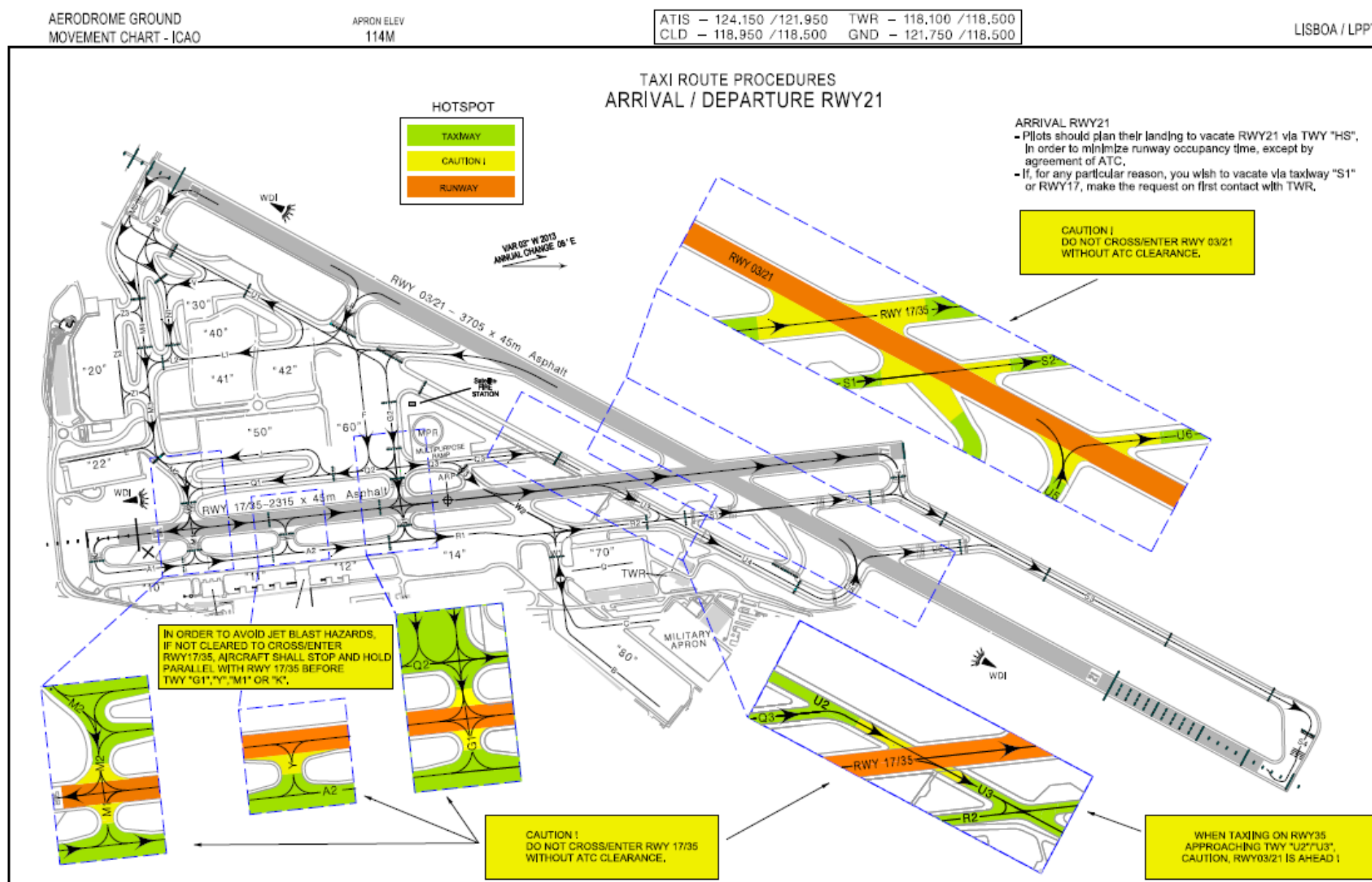

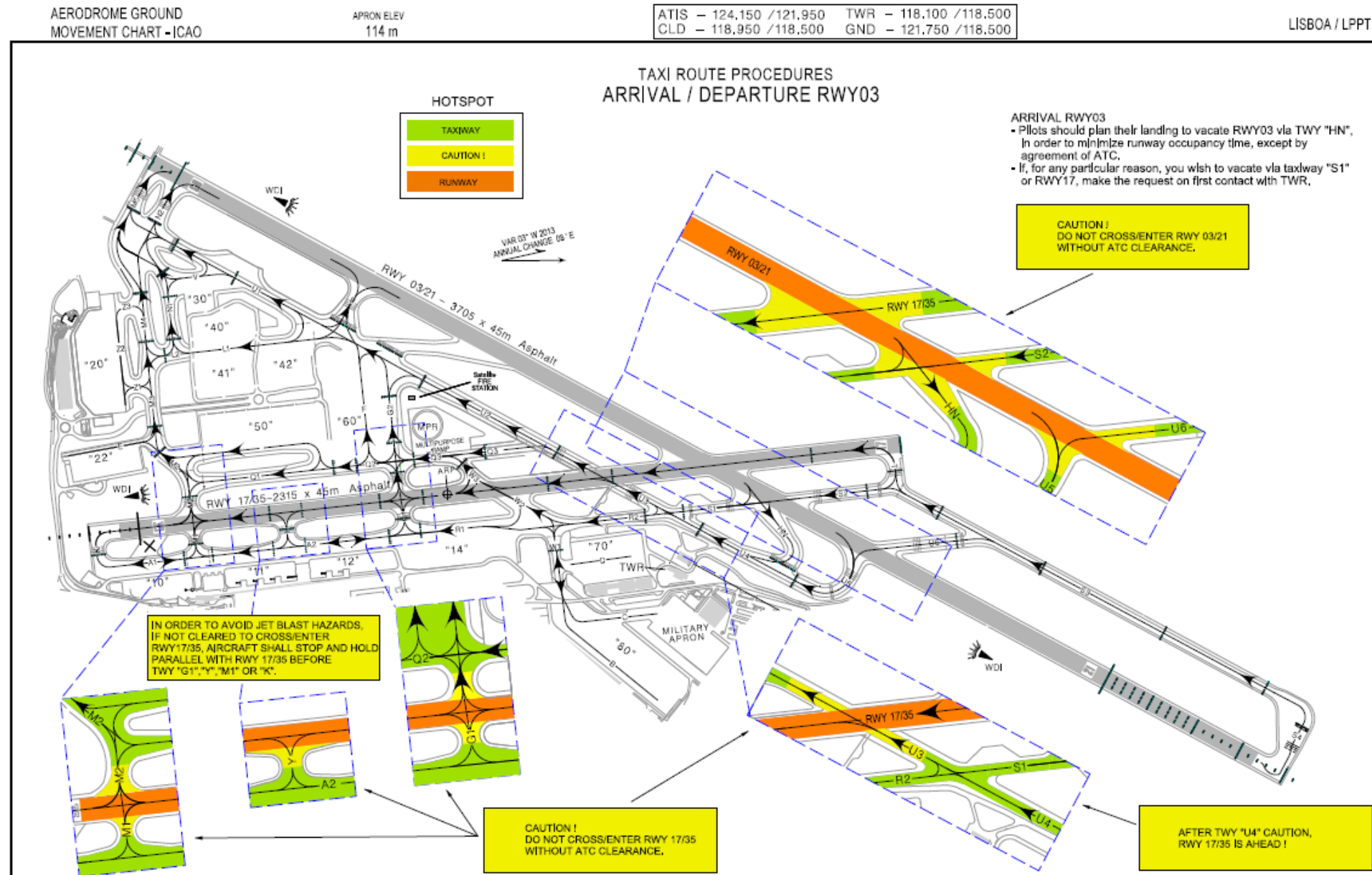

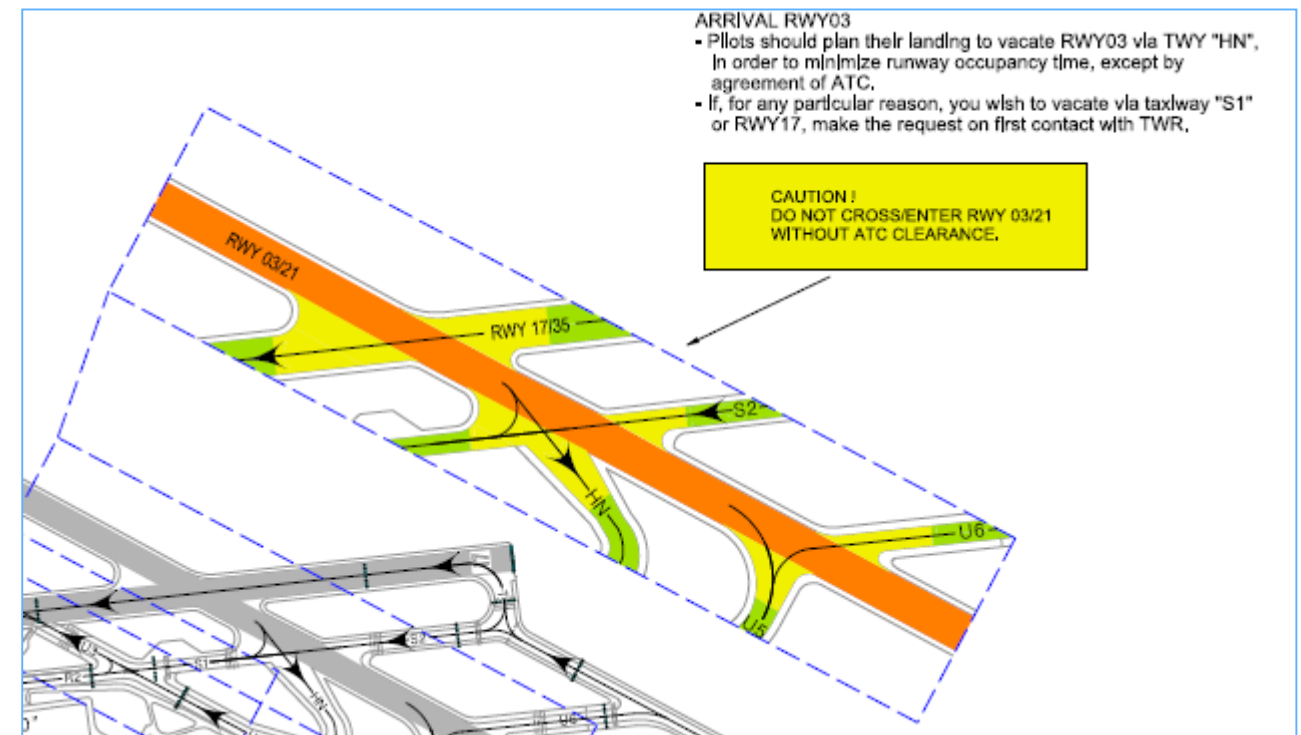
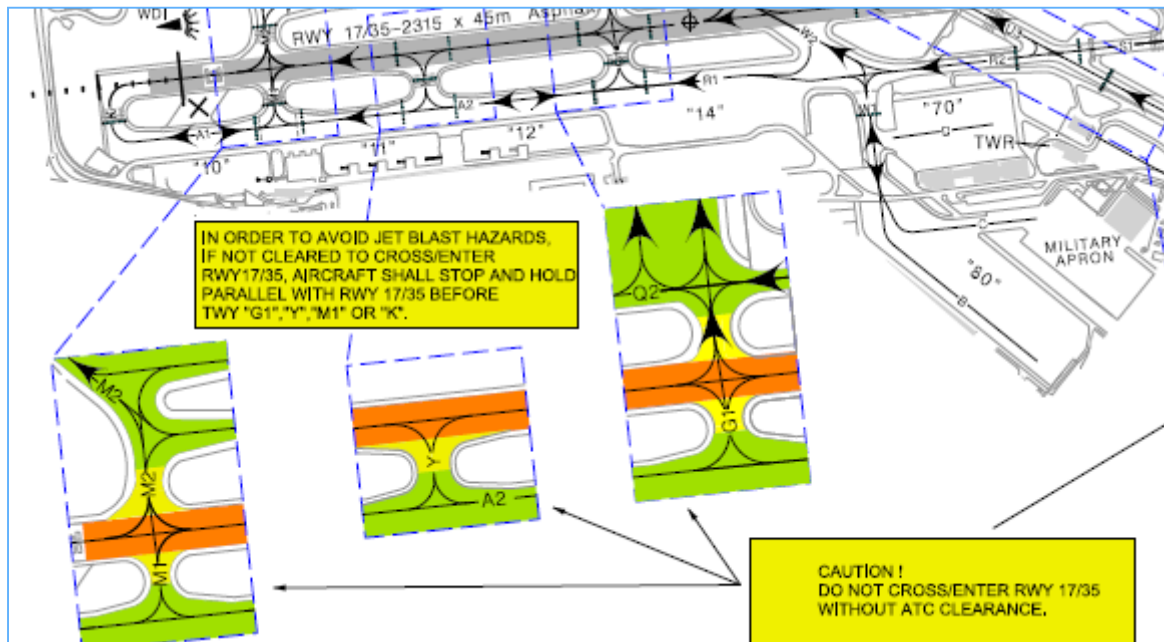



### RECENT DEVELOPMENTS

- Runway occupancy study;
- Runway protection stop bars (partially);
- ATC clearance delivery improved schedule;
- ADS-B vehicle recognition.



### OLD PROCEDURES

- Runway designation after clearance to enter, vacate, take-off or land;
- Standard EU and ICAO phraseology (just English);
- Taxi instructions:
  - Limit – holding point;
  - Reinforcement of crossing and hold short;
  - Taxi standard routes.
- Landing clearance issued at 2NM from threshold or more;
- Progressive runway inspection;
- Crossed runway operation.





# CROSSED RUNWAY OPERATION

## EAPRI'S RECOMMENDATIONS BENEFITS AT LISBON ATC TOWER

### RWY 03-21 AND RWY 35-17

- Aircraft under TWR control until crossing or being parallel;
- GND – TWR Handover;
- Runway protection stop bars;



### RUNWAY INCURSION DETECTION

- A-SMGCS alarms;
- LVO transgression beams;
- Paper flight progress board procedures.

|                |      |       |        |         |        |           |        |
|----------------|------|-------|--------|---------|--------|-----------|--------|
| <b>TAP1968</b> | 220  | DATA  | T/ASAT | INBOM3S | T/ATOT | NREG      | NEW    |
| 3353           |      | 1016/ |        | 1948    | 2025/  | 2050      | 106    |
|                |      | /N    | /      | /       | /      |           |        |
| E190           | 8    |       |        |         |        |           |        |
| LPPT           | 2015 |       |        |         |        |           |        |
|                |      | FTM   |        |         |        | AIR PORTU | RWY 21 |

|               |      |     |    |     |     |           |     |
|---------------|------|-----|----|-----|-----|-----------|-----|
| <b>TAP070</b> |      | ETA | CP | LIS | LAR |           | NEW |
|               |      | /   | /  | /   | /   |           | 608 |
|               |      |     |    |     |     |           |     |
| A332          | 717A |     |    |     |     |           |     |
| SBGL          | 0925 |     |    |     |     |           |     |
|               |      |     |    |     |     | AIR PORTU | RWY |

### RUNWAY INCURSION DETECTION

- A-SMGCS alarms;
- LVO transgression beams;
- Paper flight progress board procedures.

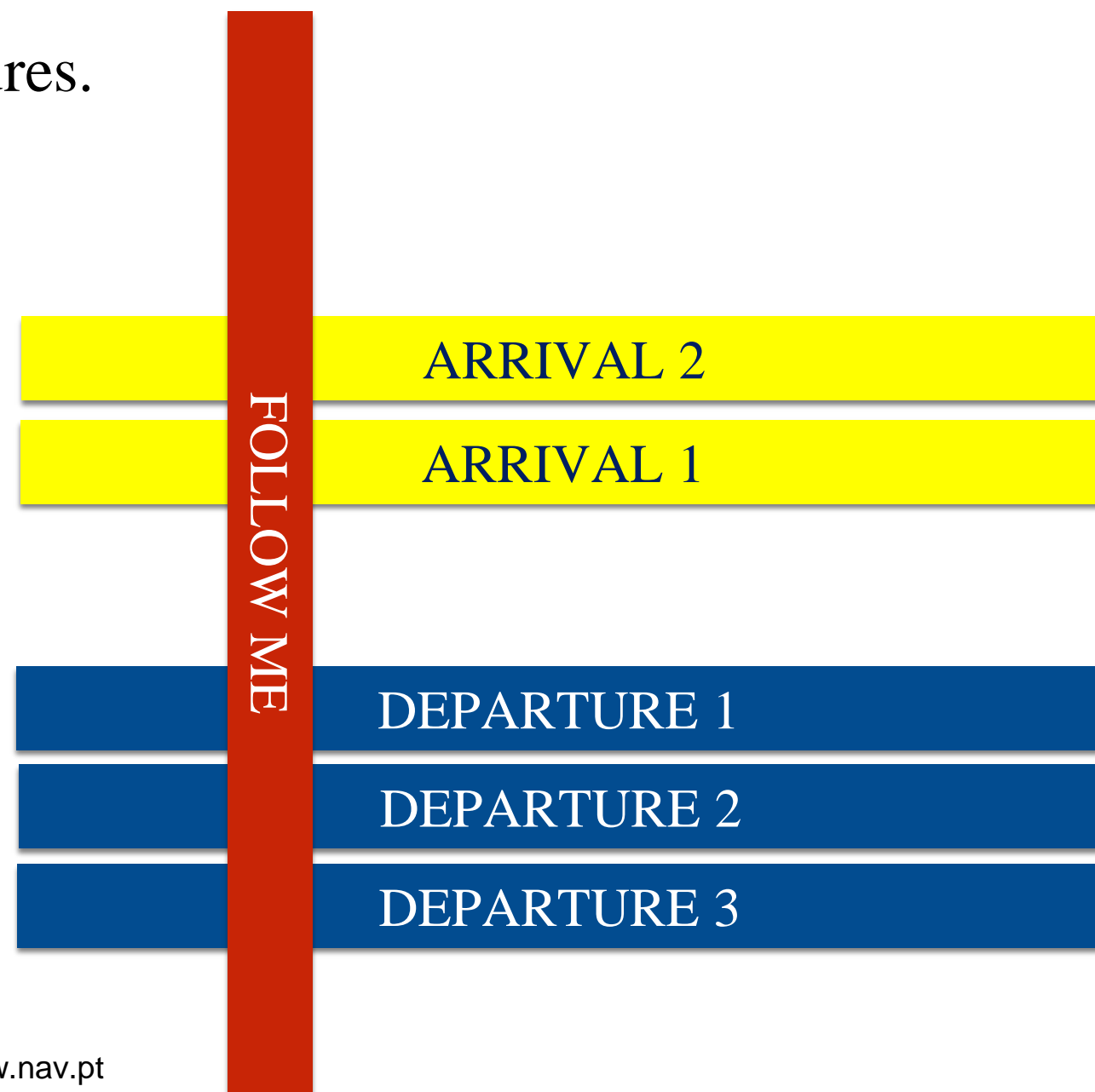

### RUNWAY INCURSION DETECTION

- A-SMGCS alarms;
- LVO transgression beams;
- Paper flight progress board procedures.

RWY 21

ARRIVAL 2

ARRIVAL 1

DEPARTURE 1

DEPARTURE 2

DEPARTURE 3



### RUNWAY INCURSION DETECTION

- A-SMGCS alarms;
- LVO transgression beams;
- Paper flight progress board procedures.

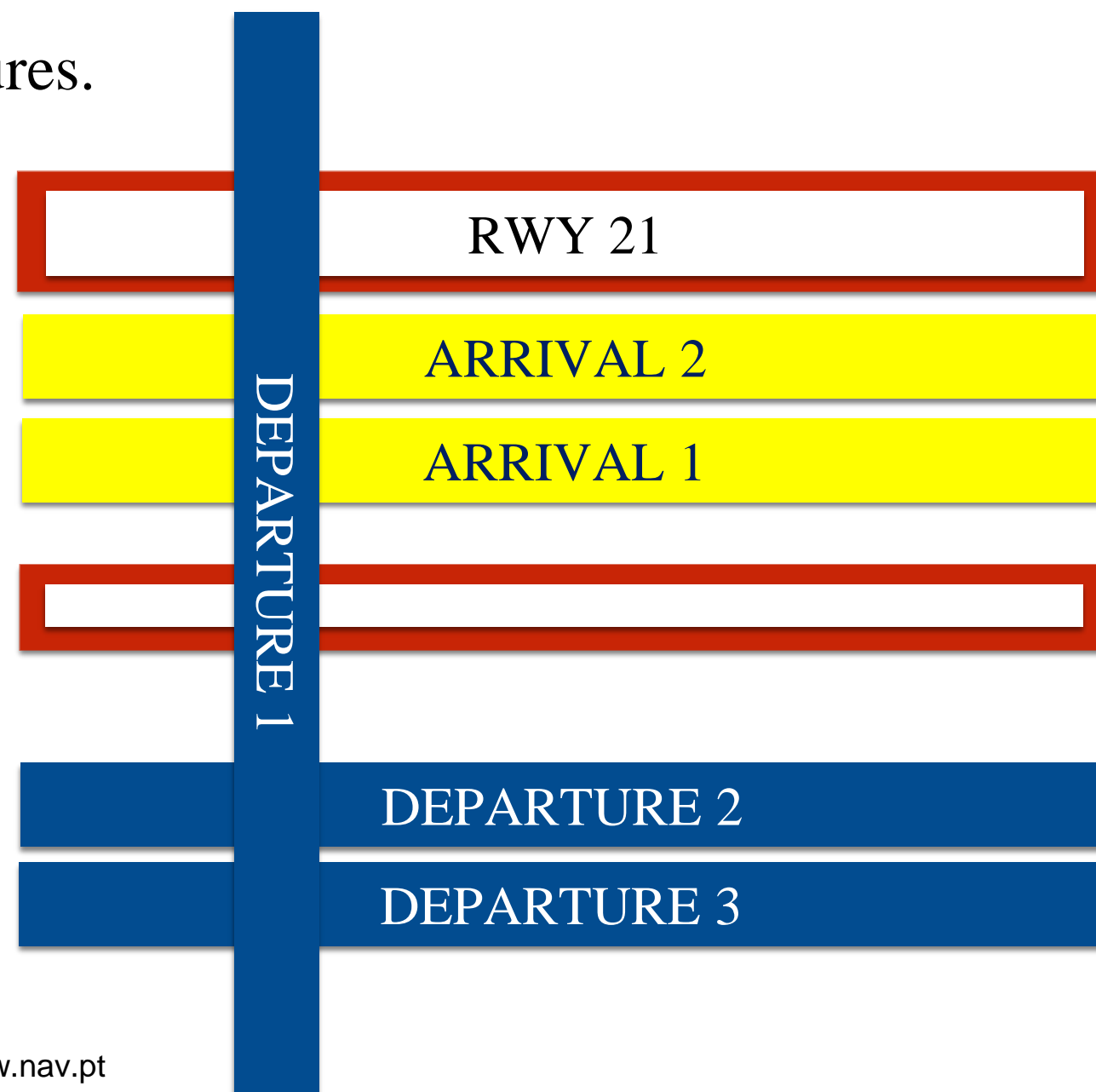

### RUNWAY INCURSION DETECTION

- A-SMGCS alarms;
- LVO transgression beams;
- Paper flight progress board procedures.

RWY 21

ARRIVAL 2

ARRIVAL 1

DEPARTURE 1

DEPARTURE 2

DEPARTURE 3

### NEAR FUTURE DEVELOPMENTS

- Electronic flight progress board alarms.



### NEAR FUTURE DEVELOPMENTS

- Electronic flight progress board alarms.

### THE PAST THREE YEARS

RWY INCURSIONS 2015 - 17

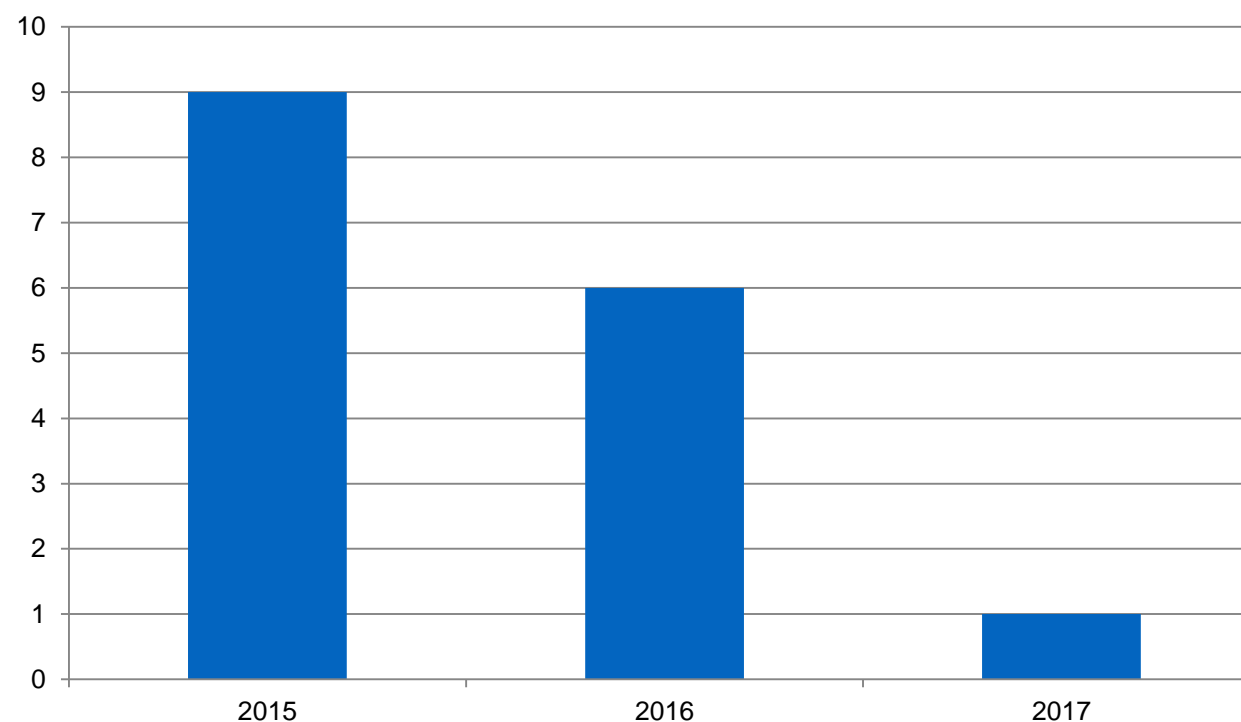





THANK YOU

LISBON  
ATC  
TOWER

---

EAPRI's RECOMMENDATIONS BENEFITS